

aluminorte Desde 1986
alumínio e acessórios

Soluções para
alumínio desde
1986

SP | GRID®
FACHADA

Sistema
Aluminorte
Catálogo completo

VERSÃO VII – Outubro 2024

SP | GRID

FACHADA

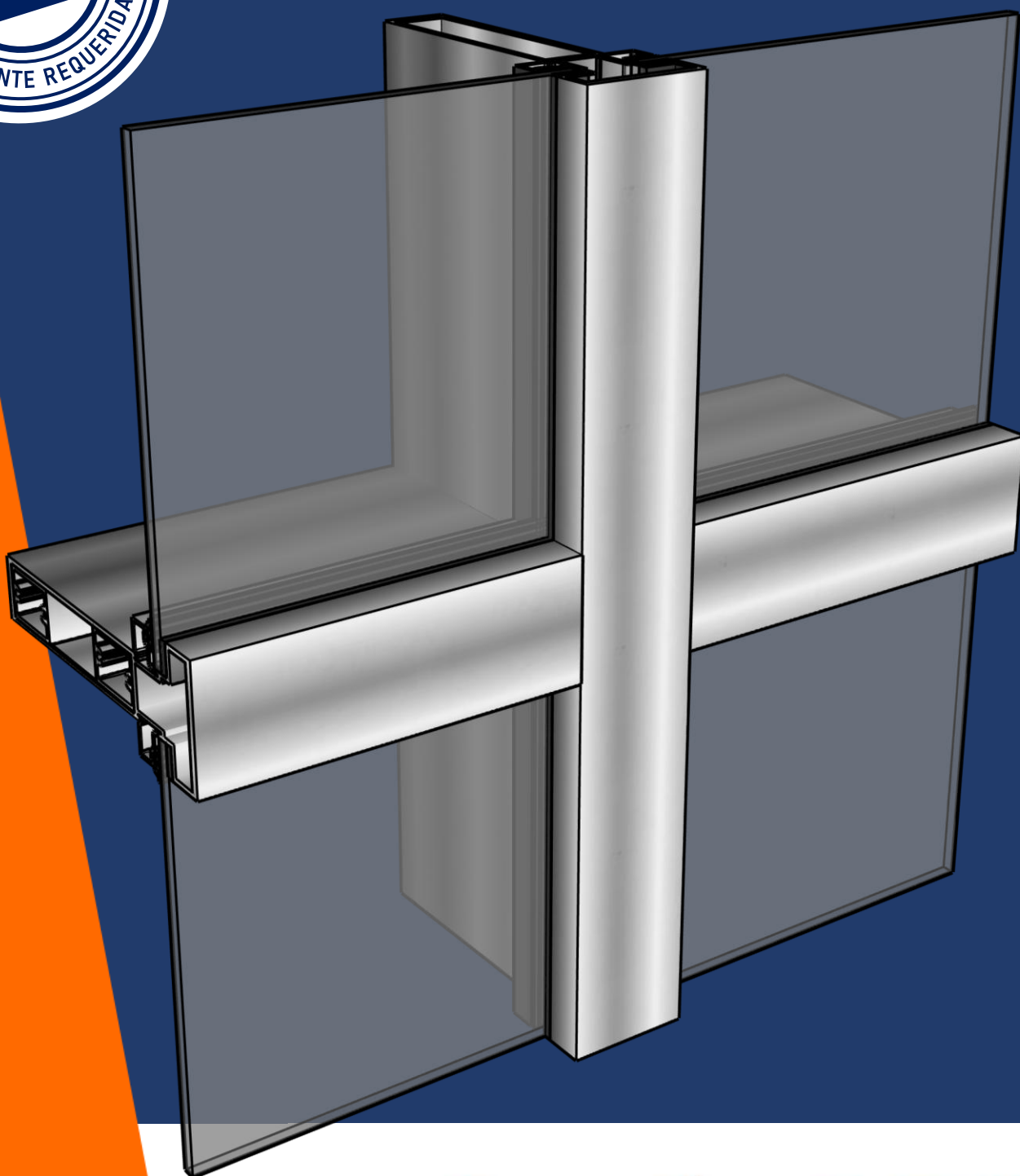

INPI INSTITUTO
NACIONAL DA
PROPRIEDADE
INDUSTRIAL

Desde 1986
aluminorte
alumínio e acessórios

Edifício Valente
Rua Capote Valente, Pinheiros – São Paulo

Arquitetura FGMF
Idea Zarvos
Esquadrias ABA

Sistema Aluminorte

Sistemas utilizados:



ÍNDICE DE PERFIS	01
PERFIS	02
COMPONENTES	15
NORMAS	21
PROJETOS ORIENTATIVOS	29



	CÓDIGO	DESCRIÇÃO	PESO	PÁG	
	BG-057	Baguete	0,167 kg/m	08	
	LG-015	Baguete	0,147 kg/m	08	
	LG-026	Baguete	0,158 kg/m	08	
	LG-027	Baguete	0,149 kg/m	08	
	LG-085	Folha	0,529 kg/m	07	
	SPG-003	Marco Glazing	0,543 kg/m	06	
	SPG-004	Folha Glazing	0,250 kg/m	07	
	SPG-005	Coluna e Travessa	2,912 kg/m	03	
	SPG-006	Coluna e Travessa	2,221 kg/m	04	
	SPG-007	Marco	0,455 kg/m	06	
	SPG-008	Tubo Fixador	0,228 kg/m	07	
	SPG-009	Coluna e Travessa	4,365 kg/m	02	
	SPG-010	Complemento da coluna de canto	1,579 kg/m	05	
	SPG – 6199	Coluna e Travessa	3.049 Kg/m	09	
	SPG – 6200	Coluna e Travessa	2,143 kg/m	10	
	SPG – 6201	Coluna e Travessa	1,088 kg/m	11	
	SPG – 6204	Contra tampa	0,688 kg/m	12	
	SPG – 6205	Tampa 21 mm	0,735 kg/m	12	
	SPG – 6206	Tampa 15 mm	0,530 kg/m	12	
	SPG – 6202	Coluna e travessa	1,503 kg/m	13	
	SPG – 6203	Tampa SPG-6202	0,477 kg/m	14	

SPG-009

Coluna e Travessa
4,626 Kg/m

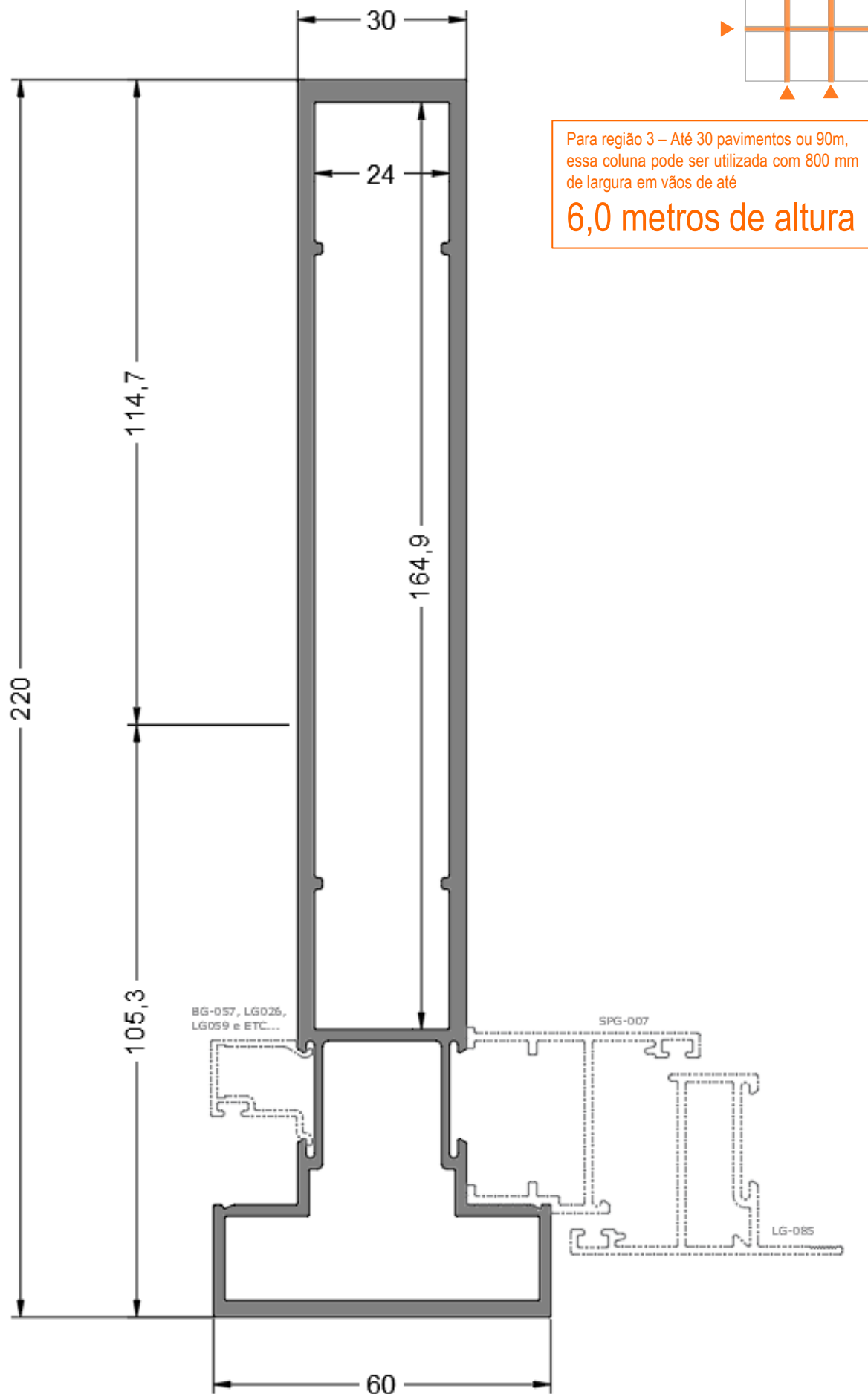

Para região 3 – Até 30 pavimentos ou 90m,
essa coluna pode ser utilizada com 800 mm
de largura em vãos de até

6,0 metros de altura

Jx= 836.8494 cm⁴

Wx= 72.959 cm³

Jy= 35.0642 cm⁴

Wy= 23.376 cm³

SPG-005

Coluna e Travessa

2,912 Kg/m

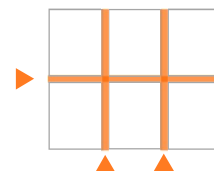

Para região 3 – Até 30 pavimentos ou 90m,
essa coluna pode ser utilizada com 800mm
de largura em vãos de até

4,5 metros de altura

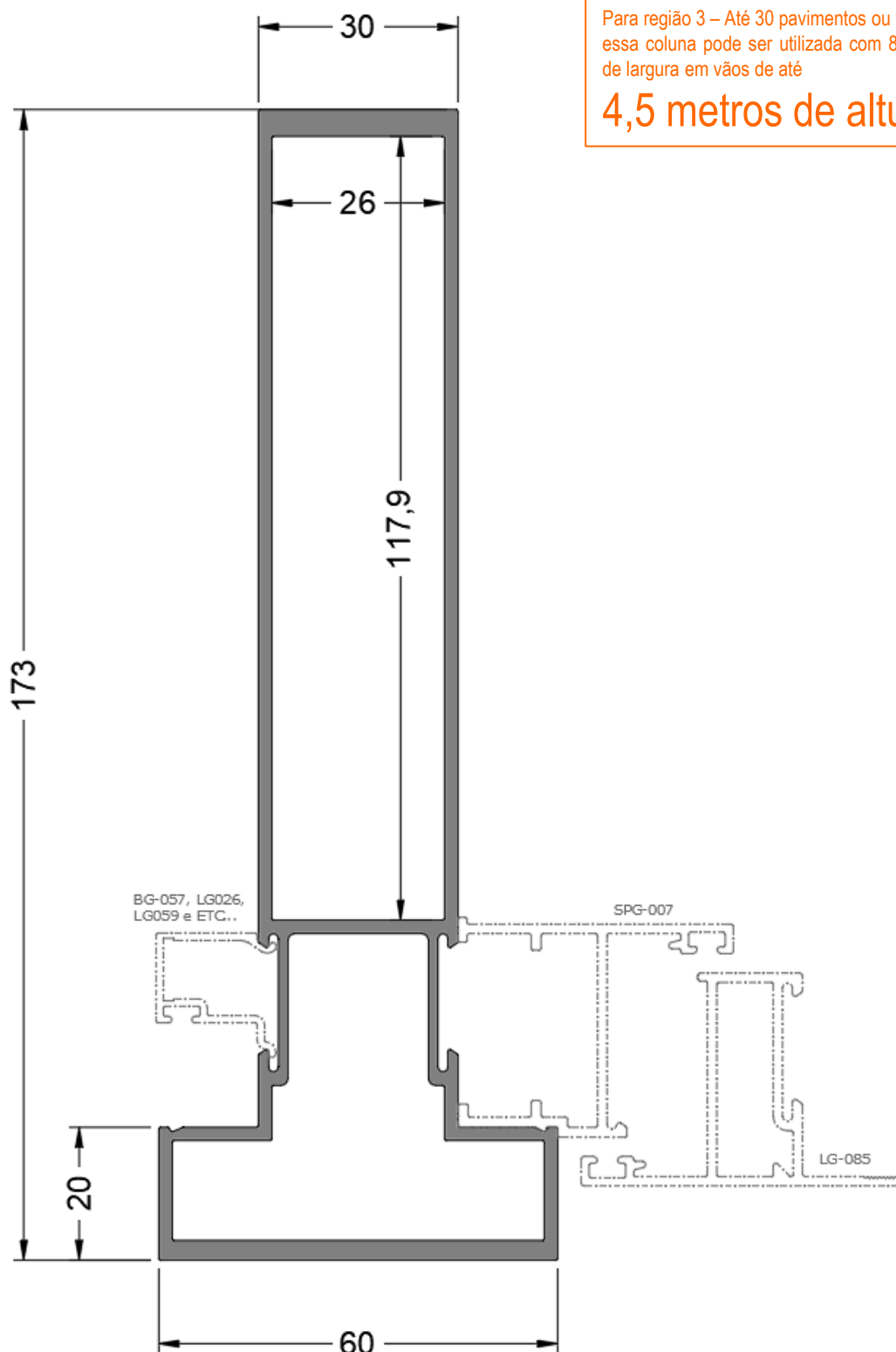

$Jx = 390.972 \text{ cm}^4$	$Wx = 40.223 \text{ cm}^3$
$Jy = 26.073 \text{ cm}^4$	$Wy = 8.691 \text{ cm}^3$

SPG-006

Coluna e Travessa

2,221 Kg/m

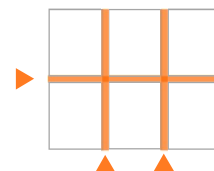

Para região 3 – Até 30 pavimentos ou 90m,
essa coluna pode ser utilizada com 800 mm
de largura em vãos de até

3,5 metros de altura

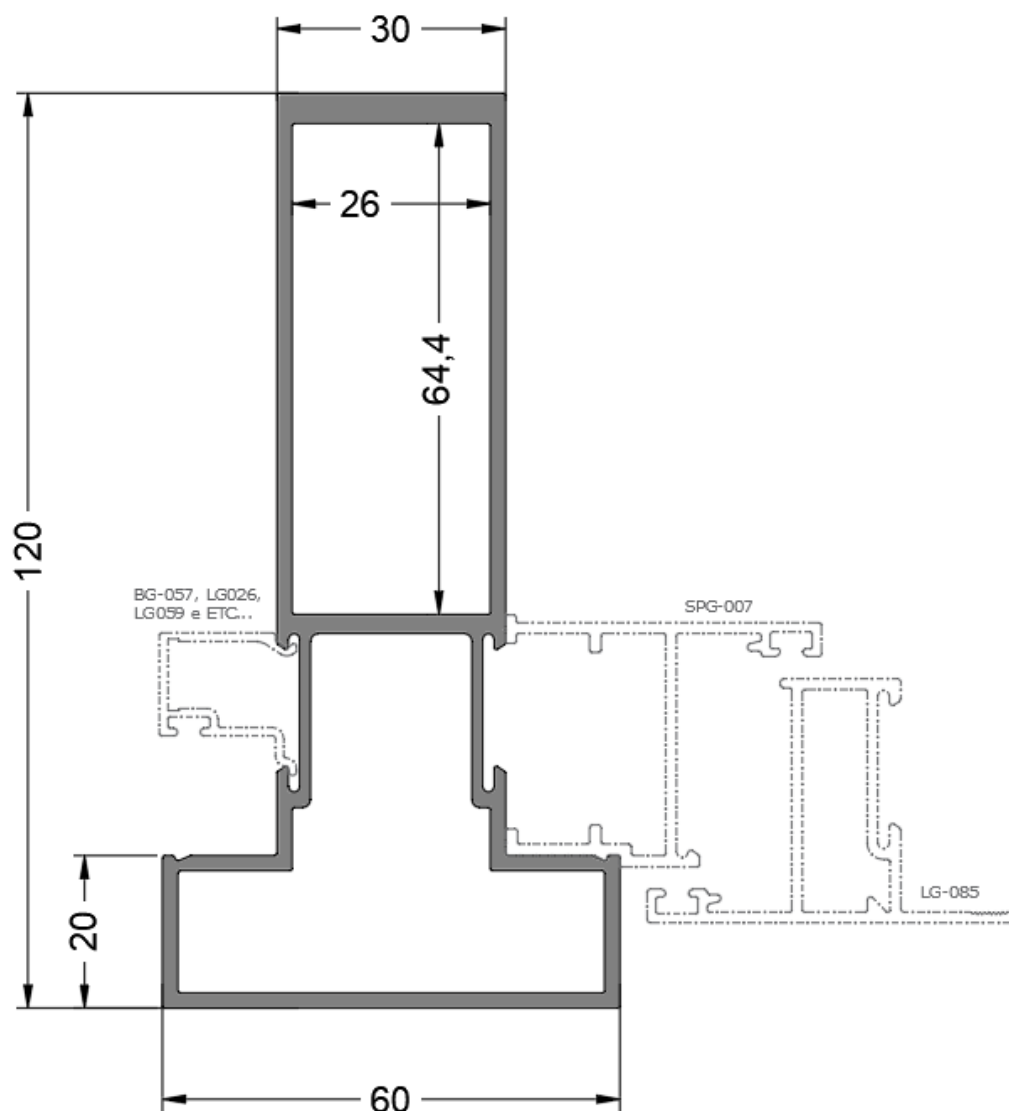

$J_x = 141,0403 \text{ cm}^4$	$W_x = 21,833 \text{ cm}^3$
$J_y = 20,521 \text{ cm}^4$	$W_y = 6,840 \text{ cm}^3$

SPG-010

Complemento coluna de canto

1,579 Kg/m

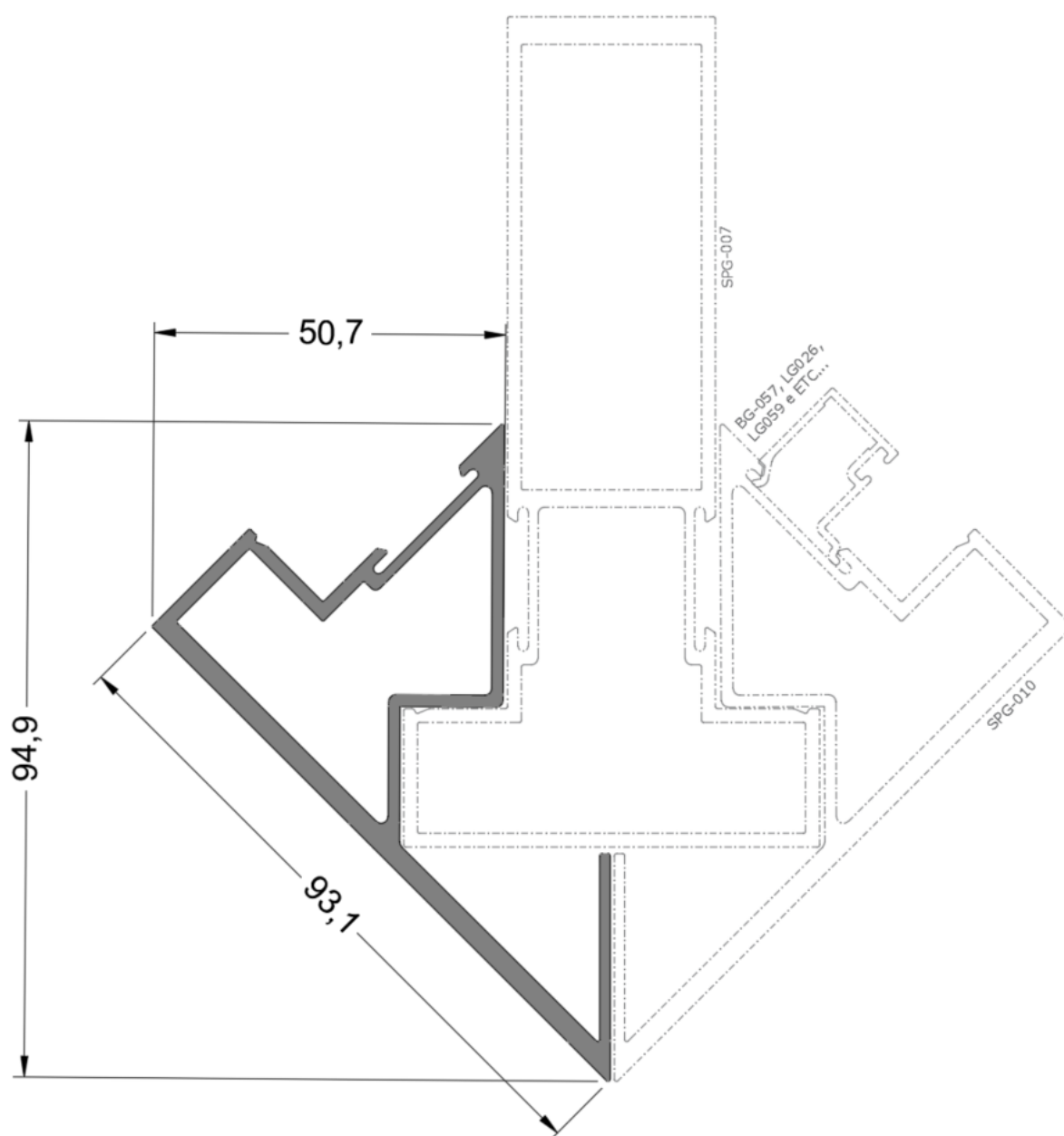
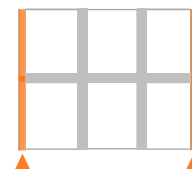

$Jx = 36,4823 \text{ cm}^4$	$Wx = 18,7930 \text{ cm}^4$
$Jy = 7,415 \text{ cm}^3$	$Wy = 5,120 \text{ cm}^3$

SPG-007

Marco
0,445 Kg/m

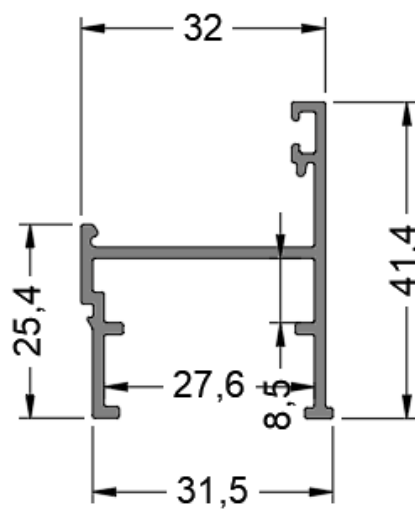
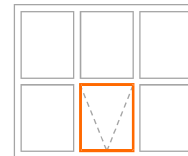

SPG-003

Marco Glazing
0,543 Kg/m

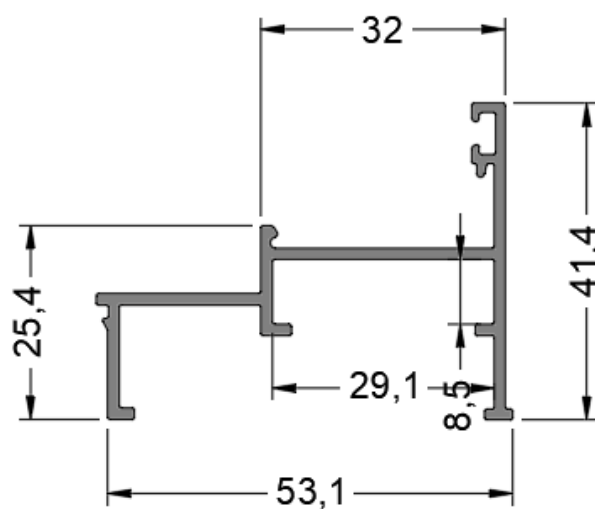
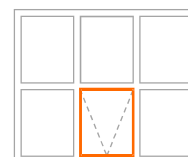

LG-085

Folha
0,529 Kg/m

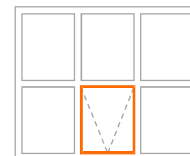
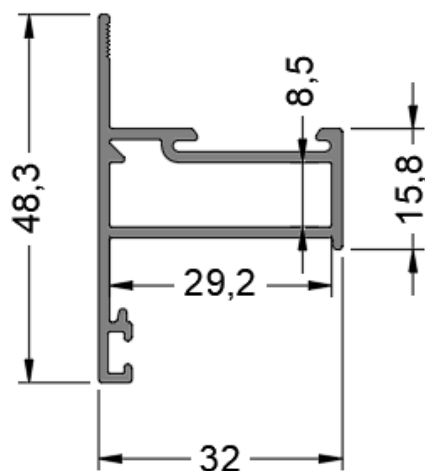

SPG-004

Folha Glazing
0,250 Kg/m

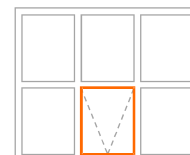
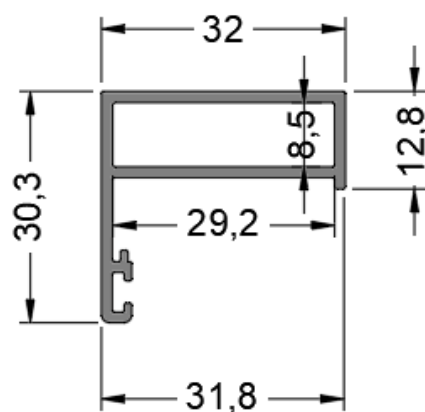

SPG-008

Fixador De Travessa
0,228 Kg/m

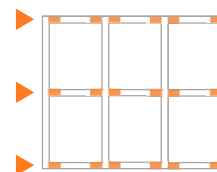
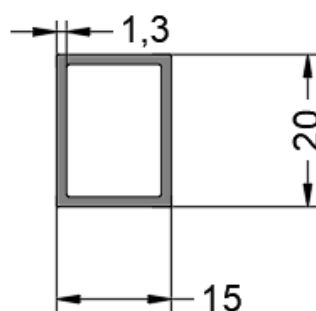

BG-057

Baguete
0,167 Kg/m

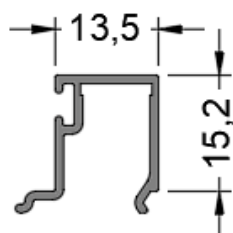

LG-027

Baguete
0,149 Kg/m

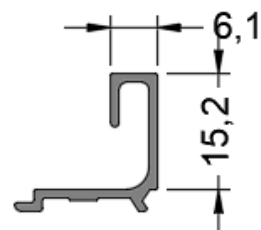

LG-026

Baguete
0,158 Kg/m

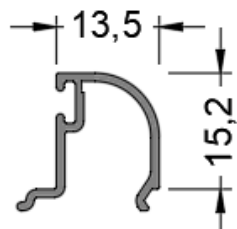
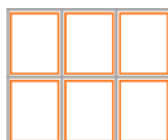

LG-015

Baguete
0,147 Kg/m

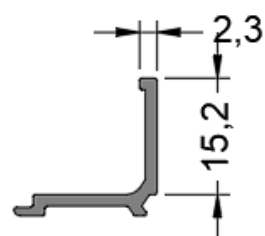
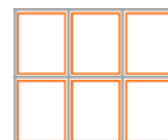

SPG-6199

Coluna e Travessa
3,049 Kg/m

Perfil sob consulta

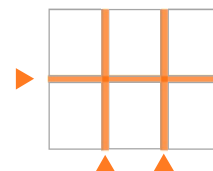

Para região 3 – Até 30 pavimentos ou 90m,
essa coluna pode ser utilizada com 800mm
de largura em vãos de até

5,2 metros de altura

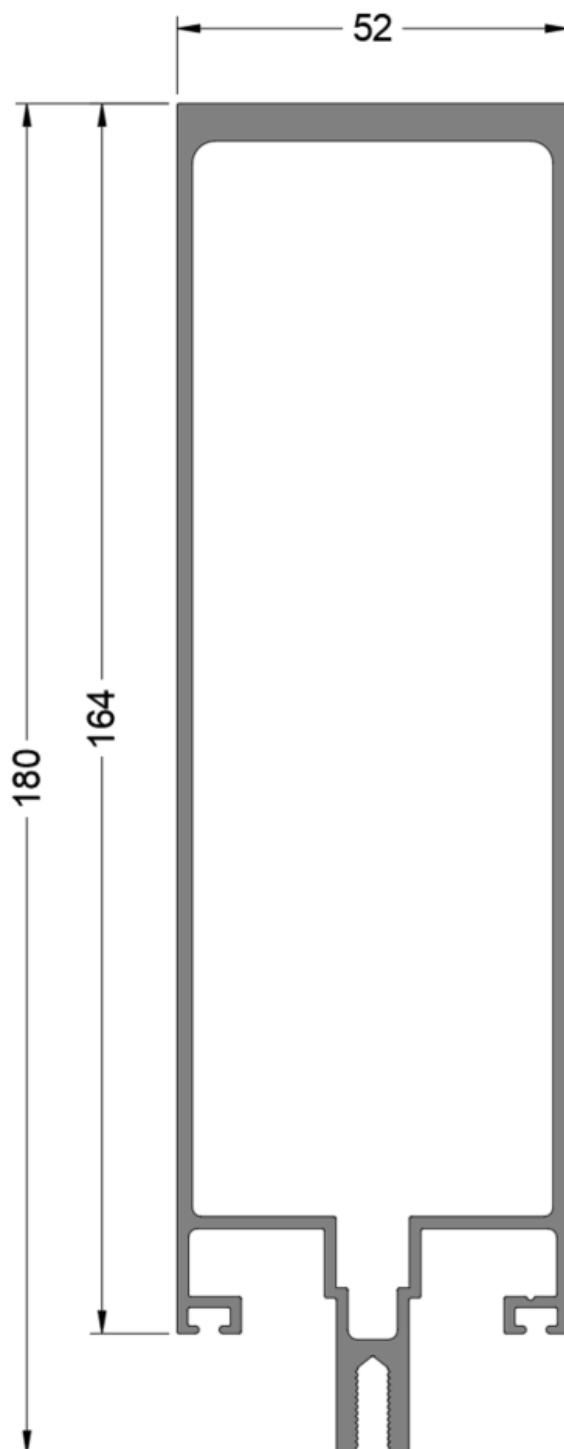

$J_x = 446.0937 \text{ cm}^4$

$W_x = 44.923 \text{ cm}^3$

$J_y = 48.1838 \text{ cm}^4$

$W_y = 18.532 \text{ cm}^3$

SPG-6200

Coluna e Travessa
2.143 Kg/m

Perfil sob consulta

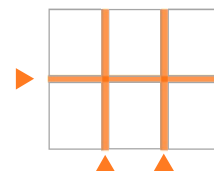

Para região 3 – Até 30 pavimentos ou 90m,
essa coluna pode ser utilizada com 800 mm
de largura em vãos de até

3,7 metros de altura

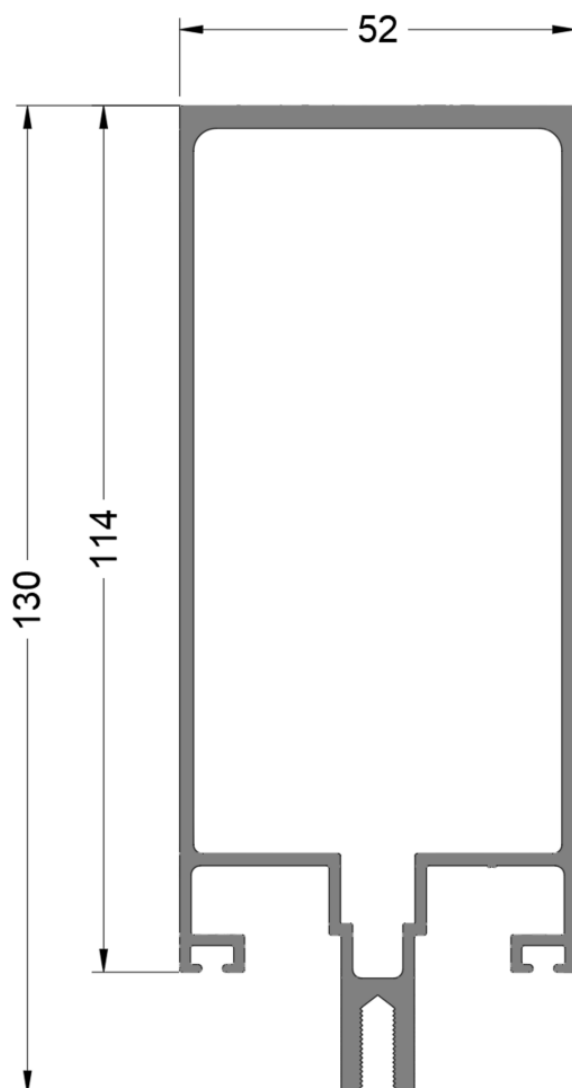

Jx= 158.6235 cm ⁴	Wx= 25.379 cm ³
Jy= 31.6437 cm ⁴	Wy= 12.170 cm ³

SPG-6201

Coluna e Travessa
1,088 Kg/m

Perfil sob consulta

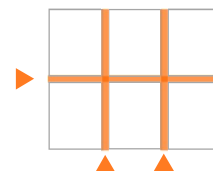

Para região 3 – Até 30 pavimentos ou 90m,
essa coluna pode ser utilizada com 800 mm
de largura em vãos de até

1,8 metros de altura

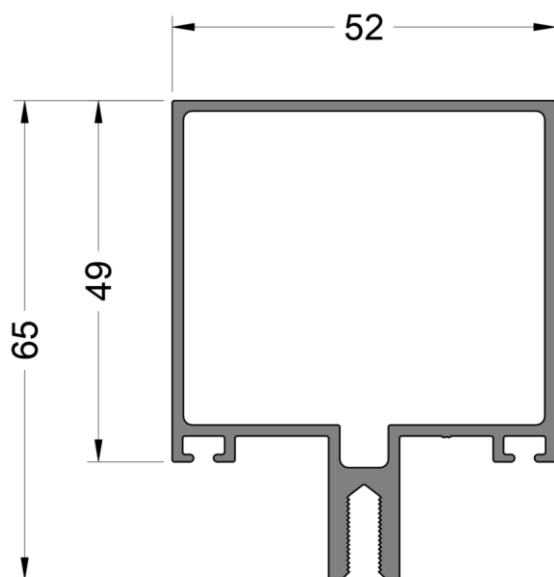

$J_x = 18.0223 \text{ cm}^4$	$W_x = 12.9660 \text{ cm}^3$
$J_y = 5.511 \text{ cm}^4$	$W_y = 4.986 \text{ cm}^3$

SPG-6204

Contra tampa
0,668 Kg/m

Perfil sob consulta

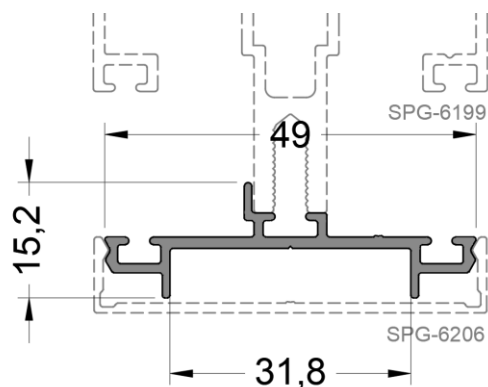
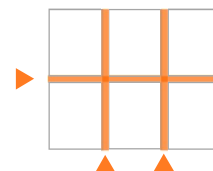

SPG-6205

Tampa 14mm
0,735 Kg/m

Perfil sob consulta

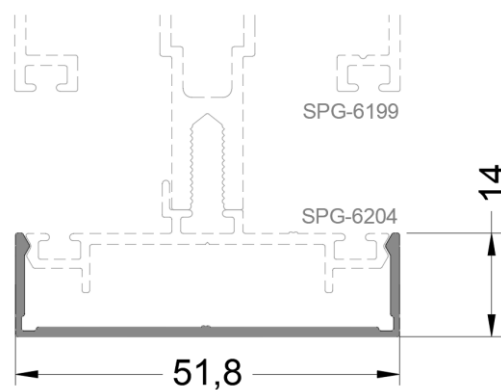

SPG-6206

Tampa 10mm
0,530 Kg/m

Perfil sob consulta

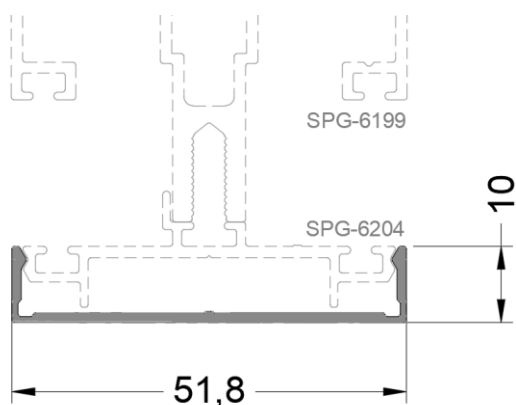

SPG-6202

Coluna e Travessa
1,503 Kg/m

Perfil sob consulta

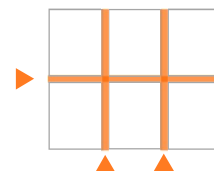

Para região 3 – Até 30 pavimentos ou 90m,
essa coluna pode ser utilizada com 800 mm
de largura em vãos de até

3,4 metros de altura

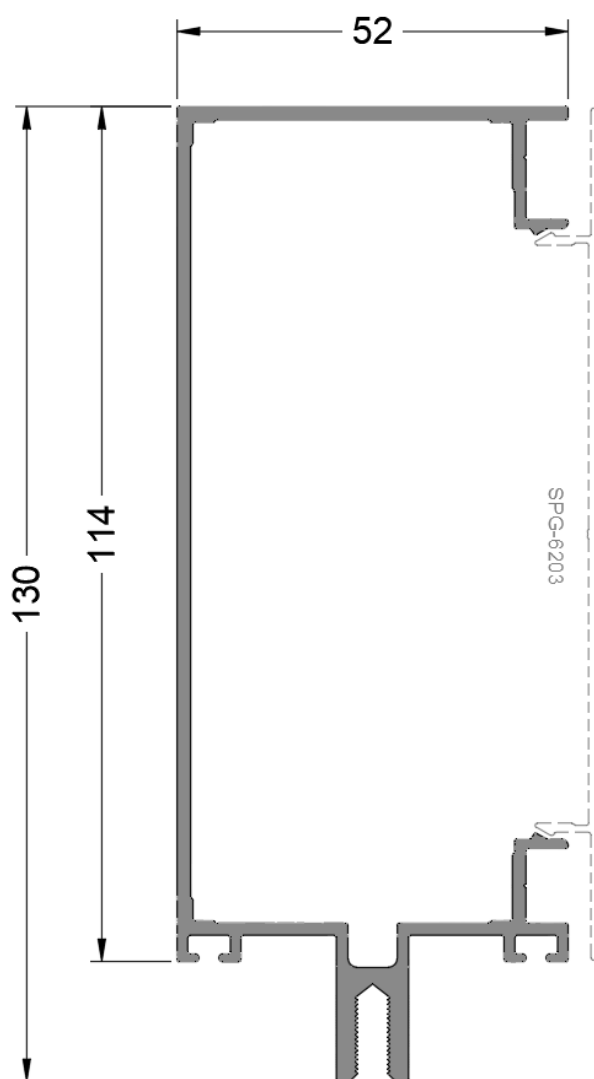



$Jx = 390.972 \text{ cm}^4$	$Wx = 40.223 \text{ cm}^3$
$Jy = 26.073 \text{ cm}^4$	$Wy = 8.691 \text{ cm}^3$

SPG-6203

Tampa
0,477 Kg/m

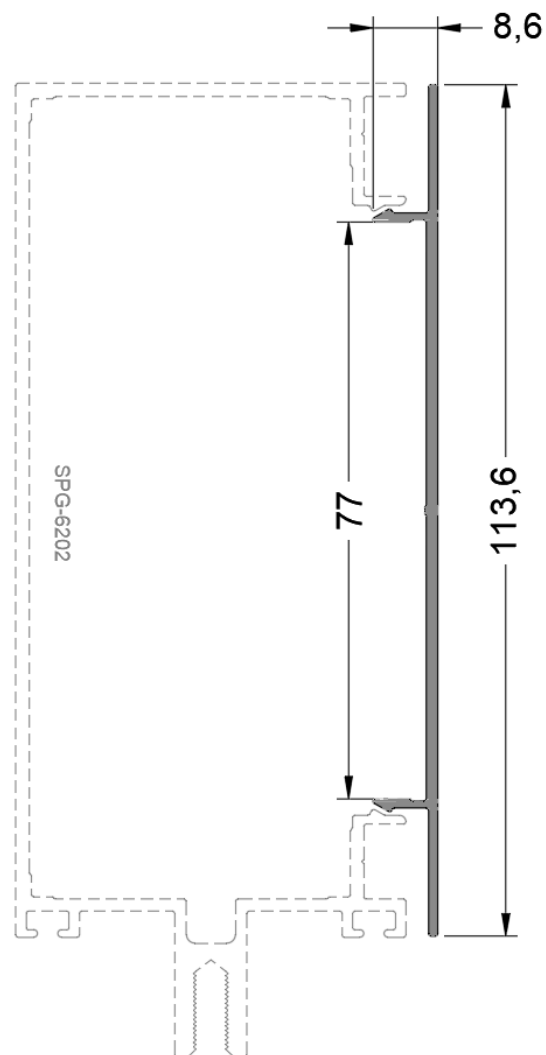
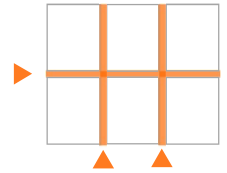
Perfil sob consulta

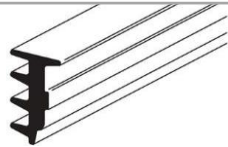

ACESSÓRIO	CÓDIGO	DESCRIÇÃO
	BRAUDMAX 17PD	Braço Projetante (Pág. 8)
	CHUPRP380AINX	Chumbador Expansivo com Prolongador 3/8" x 110 mm – aço Inox
	CHUPFP3802INX	Chumbador Expansivo com prolongador 3/8" x 114 mm – aço inox
	GUA239	Guarnição do Marco EPDM Preto (Pág. 07)
	GUA259	Guarnição do Vidro EPDM Preto (Pág. 07)
	GUA 304	Guarnição Adesiva Esponjosa 14 mm x 6,4 mm – Preta (Pág.07)
	GUA306	Guarnição Adesiva Esponjosa 14 mm x 4,8 mm – Preta (Pág.07)
	FECHO 6735D	Fecho Maxim-ar 6735dD Gold c/ CCTF B7 – Udinese (Pág.09)
	FECHO 735D	Fecho Maxim-ar 735D Gold c/ CCTF B7 – Udinese (Pág.10)
	PAR4213	Parafuso AA Ø 4,2 x 13 mm
	PAR4216	Parafuso AA Ø 4,2 x 13 mm (auto brocante)
	PAR4219	Parafuso AA Ø 4,2 x 19 mm

ACESSÓRIO	CÓDIGO	DESCRIÇÃO
	GUA-2101-PRT	Vidro 10 mm
	GUA-2102-PRT	Vidro 8 mm
	GUA-2103-PRT	Vidro 6 mm
	PRX-PRM-5016-NAT	Parafuso INOX

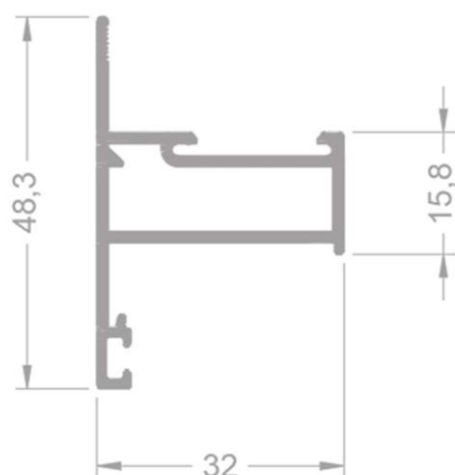
LG-085

DETALHES		Espessura Vidro (mm)	Guarnição Interna	Guarnição Externa
BG-057 ou LG-056		8	GUA259	GUA304
		10	GUA259	GUA306
LG-027		18	GUA259	GUA306
LG-015		22	GUA259	GUA306

VERSÃO	COR	CÓDIGO UDINESE	CÓDIGO UNIVERSAL	LARGURA MÁX. DA FOLHA (mm)	ALTURA MÁX. DA FOLHA (mm)	CARGA MÁX. (kg)
350	BCO	9103129	BRAUDMAX17PD350BCO	1500	600	22
	PRE	9103132	BRAUDMAX17PD350PTF			
600	BCO	9103134	BRAUDMAX17PD600BCO	1500	1000	35
	PRE	9103137	BRAUDMAX17PD600PTF			
950	BCO	9103139	BRAUDMAX17PD950BCO	1500	1200	42
	PRE	9103142	BRAUDMAX17PD950PTF			
1200	BCO	9103144	BRAUDMAX17PD12000BCO	1500	1500	74
	PRE	9103147	BRAUDMAX17PD12000PTF			

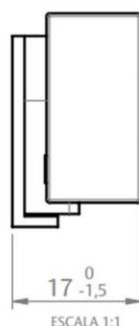
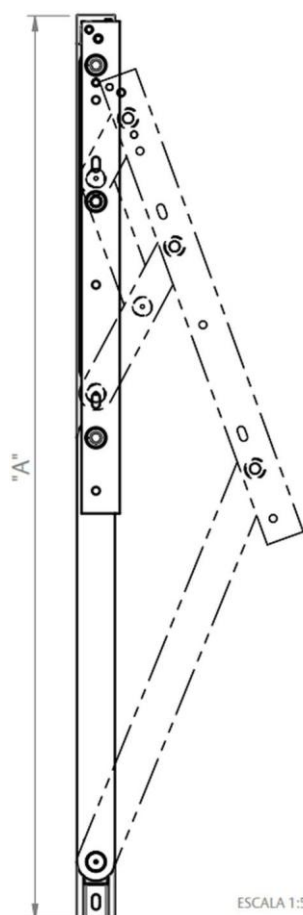

APLICAÇÃO

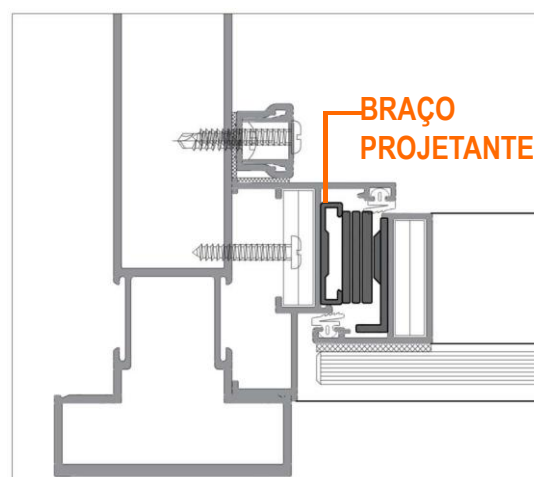

FECHO MAX-AR 6735D GOLD C/ CCTF B7

UDiNESE
ASSA ABLOY

POSIÇÃO	COR	CÓDIGO	CÓDIGO CATÁLOGO
DIREITO	BCO	9210735	FEC6735DGB7BCO
	PRA	9210736	FEC6735DGB7PRA
	PTF	9210737	FEC6735DGB7PTF
ESQUERDO	BCO	9210738	FEC6735EGB7BCO
	PRA	9210739	FEC6735EGB7PRA
	PTF	9210740	FEC6735EGB7PTF

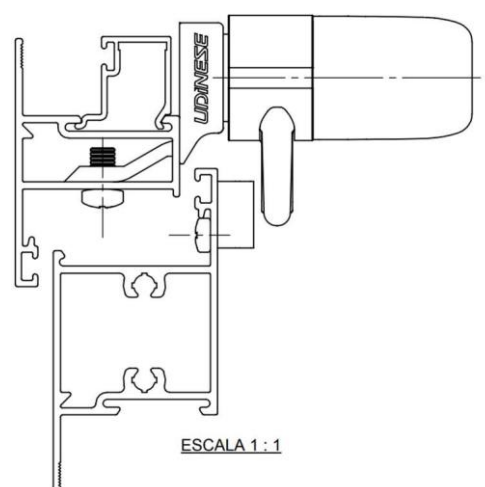
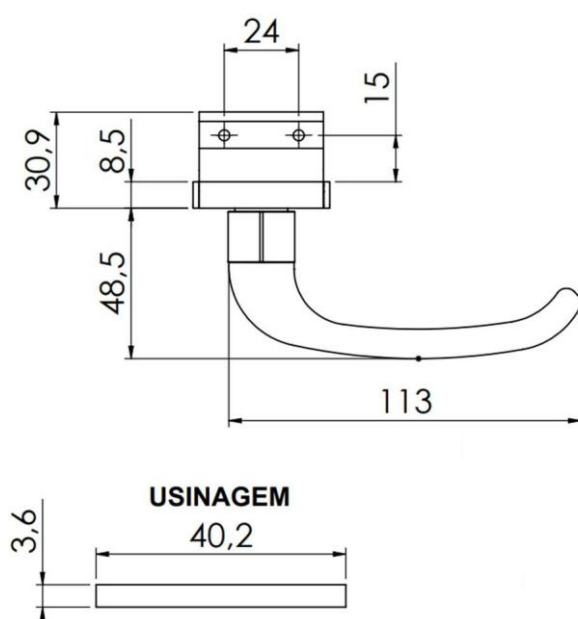

ESCALA 1:1

FECHO MAX-AR 735D GOLD C/ CTF B7



UDINESE
ASSA ABLOY

POSIÇÃO	COR	CÓDIGO	CÓDIGO CATÁLOGO
DIREITO	BCO	9210735	FEC735DGOLDBCO
	PRA	9210736	FEC735DGOLDPRA
	PTF	9209334	FEC735DGOLDPTF
ESQUERDO	BCO	9206789	FEC735EGOLDBCO
	PRA	9209657	FEC735EGOLDPRA
	PTF	9209362	FEC735EGOLDPTF

INSTRUÇÃO DE MONTAGEM E USINAGEM

IMAGEM MERAMENTE ILUSTRATIVA

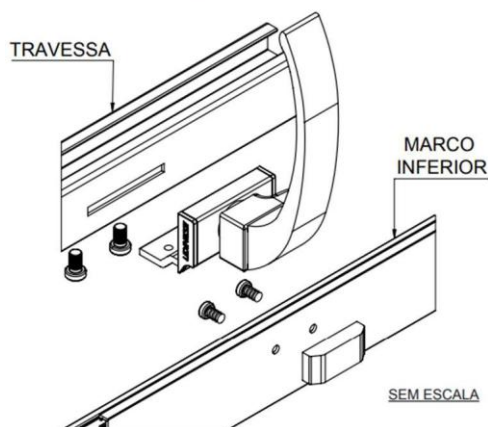

USINAGEM DA TRAVESSA

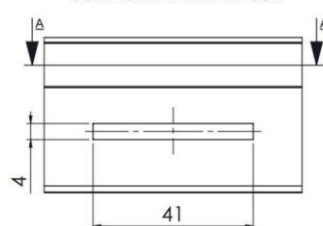

SEÇÃO A-A

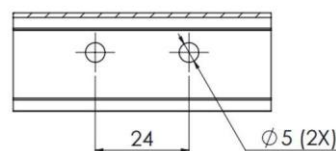

REFERÊNCIA DE USINAGEM

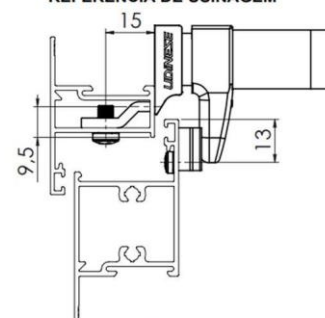

USINAGEM DO MARCO INFERIOR

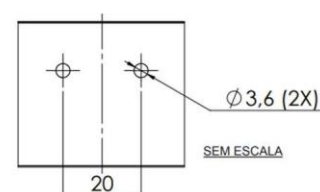

DIMENSÕES

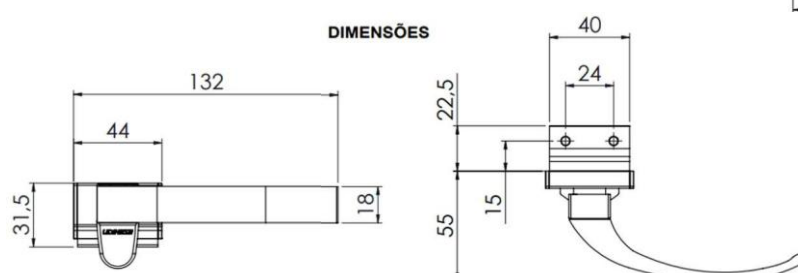

No Brasil, o comportamento de uma esquadria está regulamentado pela Norma **ABNT NBR 10.821**. Esta norma determina os parâmetros de desempenho mínimas de caixilhos em edificações residenciais e comerciais.

A velocidade do vento é o fator inicial para calcular a pressão do vento no local desejado.

Isopletas dos Ventos (em metros por segundo)

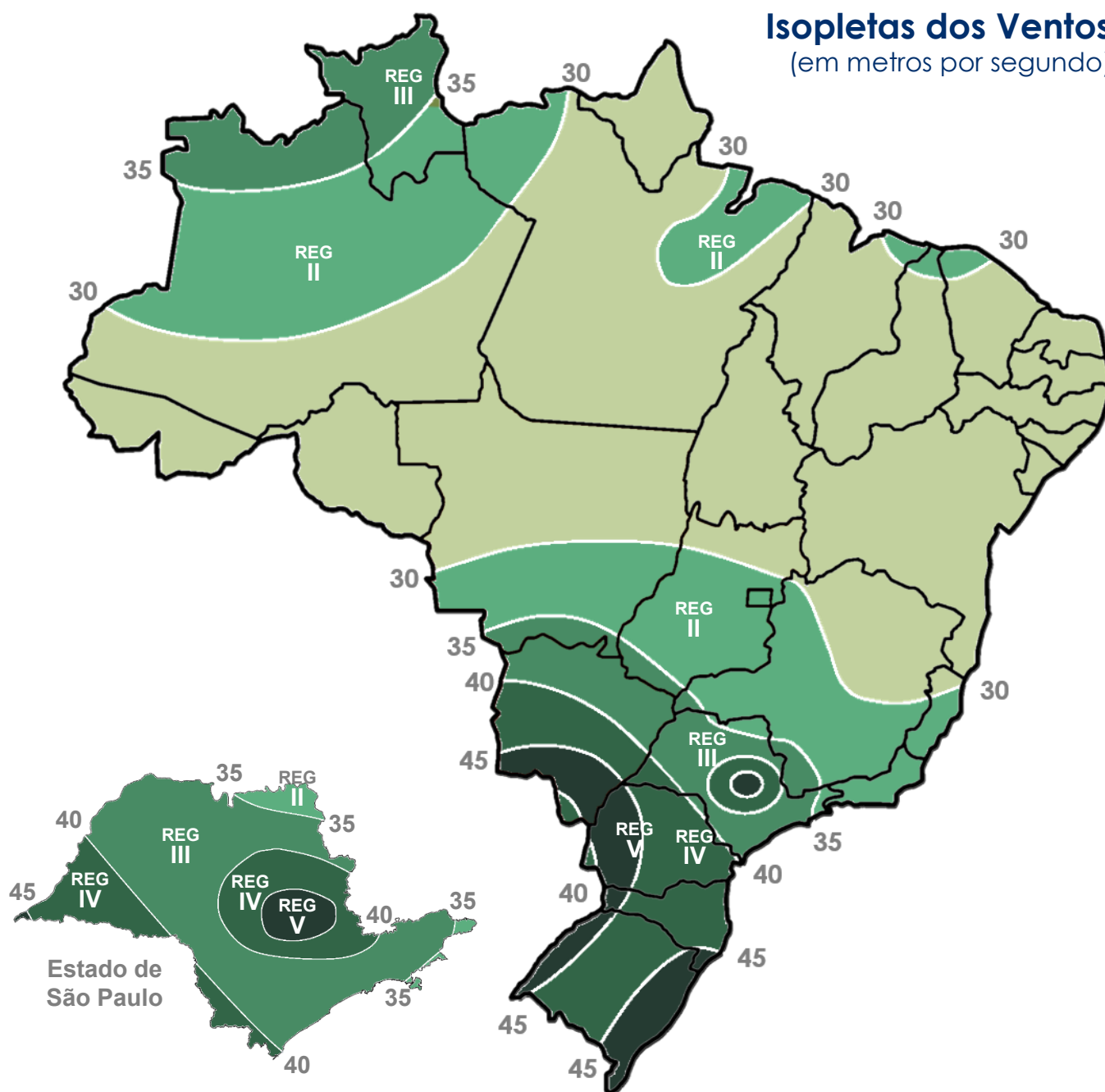

VELOCIDADE DO VENTO POR REGIÃO CONSIDERADA NA NORMA ABNT NBR 10.821

REGIÃO 1	REGIÃO 2	REGIÃO 3	REGIÃO 4	REGIÃO 5
até 30 m/s até 108 km/h	30 - 35 m/s 108 – 126 km/h	35 - 40 m/s 126 – 144 km/h	40 - 45 m/s 144 – 162 km/h	45 - 50 m/s 162 – 180 km/h

QUANTIDADE DE PAVIMENTOS	ALTURA MÁXIMA	REGIÕES DO PAÍS	PRESSÃO DO ENSAIO	PRESSÃO DE SEGURANÇA	PRESSÃO DE ÁGUA
			Pe em (Pa) Positiva e negativa $Pe - Pp \times 1,2$	Ps em (Pa) Positiva e negativa $Ps - Pp \times 1,5$	Pa em (Pa) Positiva e negativa $Pa - Pp \times 0,2$
02	6 m	I	350	520	60
		II	470	700	80
		III	610	920	100
		IV	770	1160	130
		V	950	1430	160
05	15 m	I	420	640	70
		II	580	860	100
		III	750	1130	130
		IV	950	1430	160
		V	1180	1780	200
10	30 m	I	500	750	80
		II	680	1030	110
		III	890	1340	150
		IV	1130	1700	190
		V	1400	2090	230
20	60 m	I	600	900	100
		II	815	1220	140
		III	1060	1600	180
		IV	1350	2020	220
		V	1660	2500	280
30	90 m	I	660	980	110
		II	890	1340	150
		III	1170	1750	200
		IV	1480	2210	250
		V	1820	2730	300

Coluna e travessa de 120mm

SPG-006

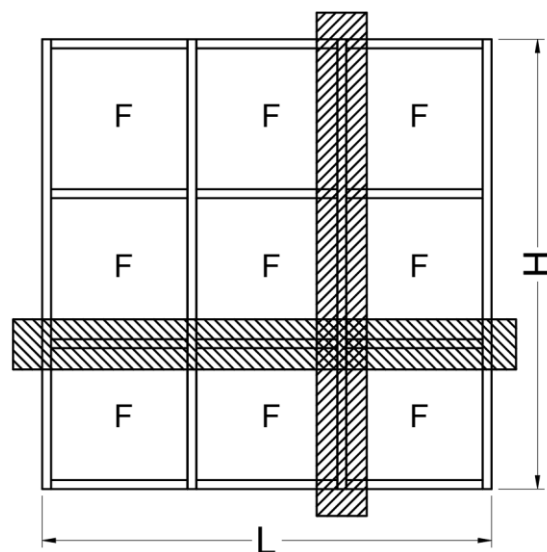
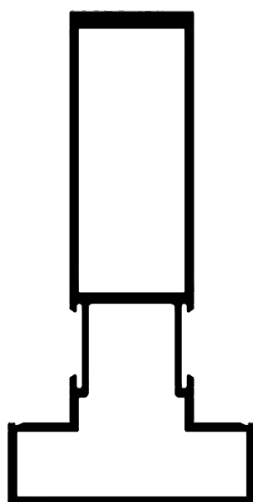

SPG-006

$$J_x = 141,0434 \text{ cm}^4$$

$$W_x = 21,833 \text{ cm}^3$$

$$J_y = 20,5213 \text{ cm}^4$$

$$W_y = 6,840 \text{ cm}^3$$

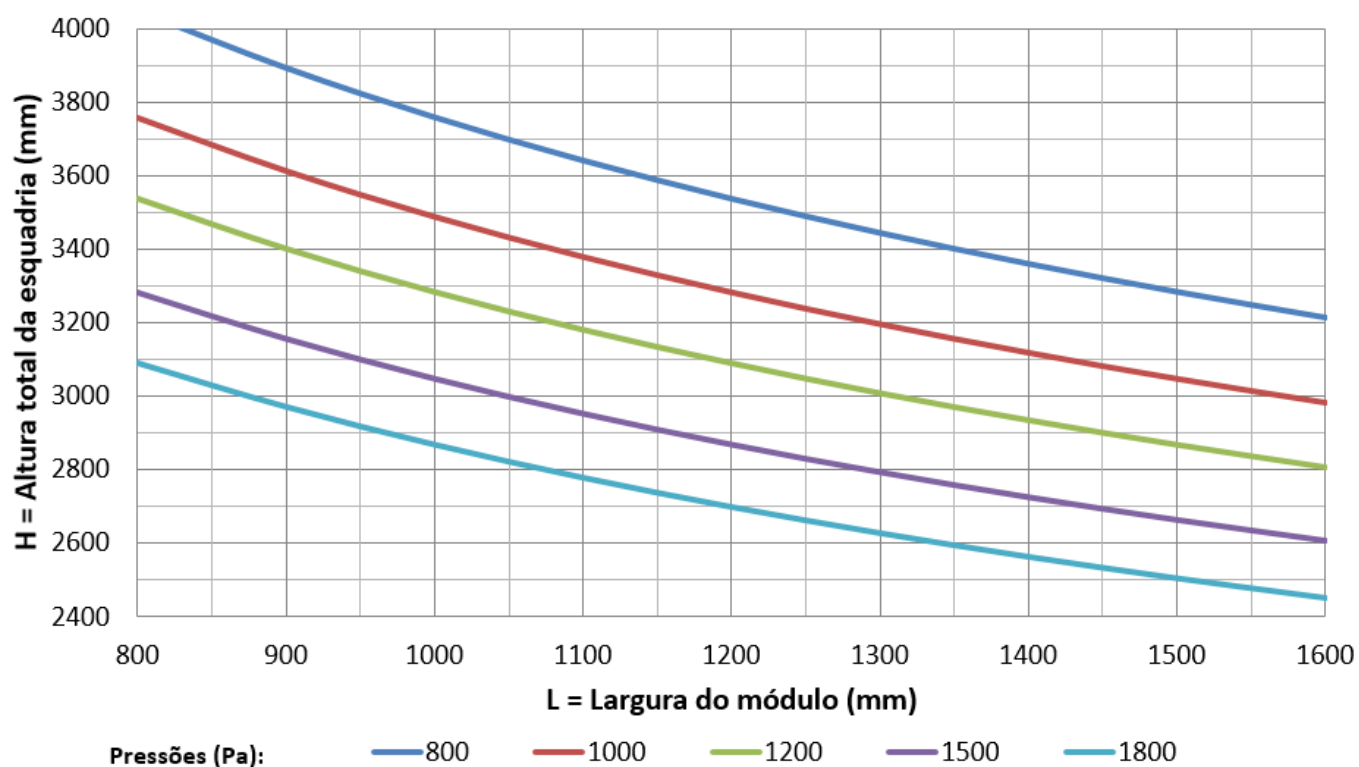

Coluna e travessa de 173mm

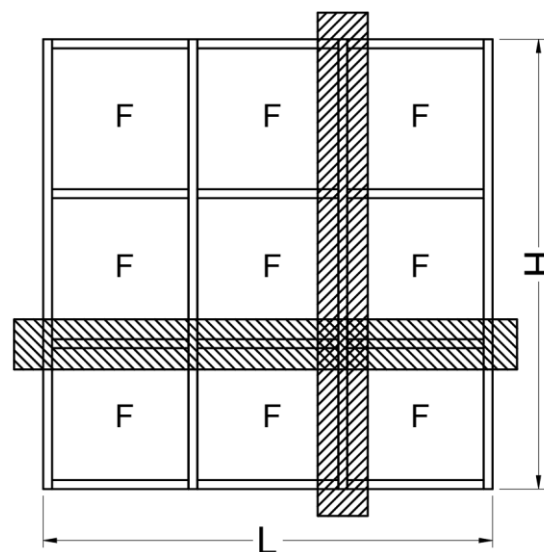
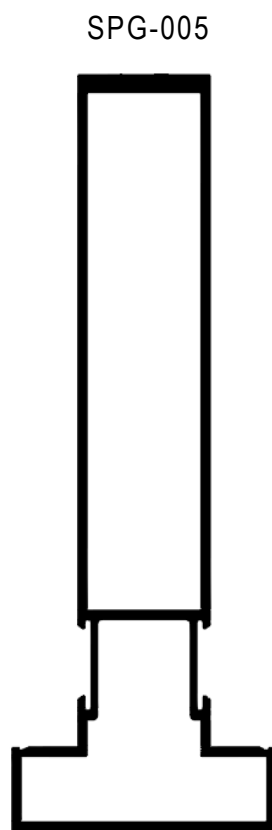

SPG-005

$$J_x = 390,9729 \text{ cm}^4$$

$$W_x = 40,223 \text{ cm}^3$$

$$J_y = 26,0738 \text{ cm}^4$$

$$W_y = 8,691 \text{ cm}^3$$

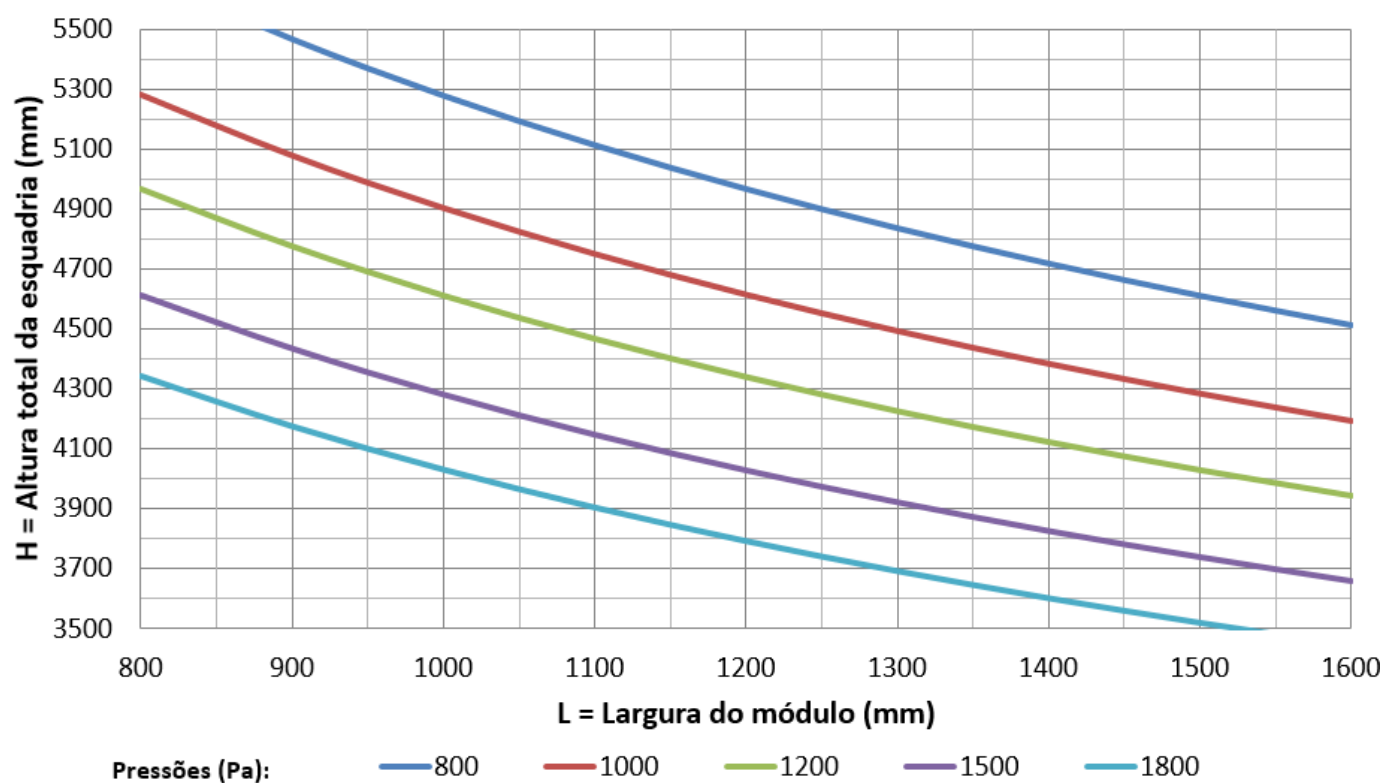

Coluna e travessa de 220mm

SPG-009

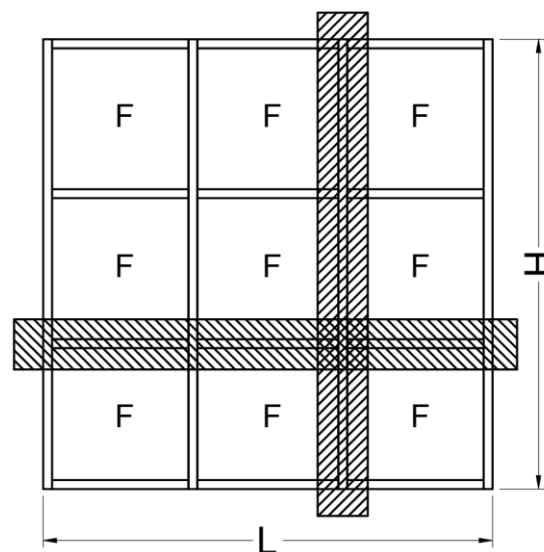
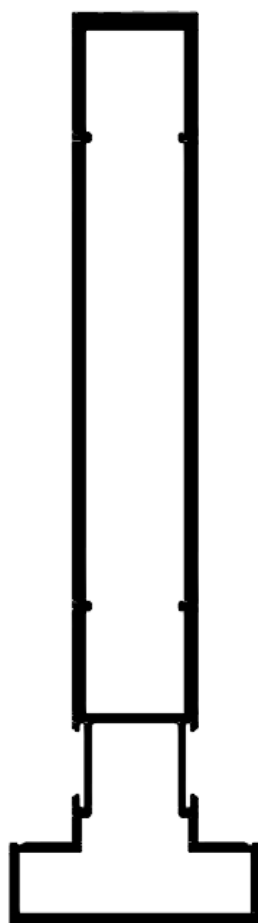

SPG-009

$$J_x = 836,8494 \text{ cm}^4$$

$$W_x = 72,959 \text{ cm}^3$$

$$J_y = 35,0642 \text{ cm}^4$$

$$W_y = 23,376 \text{ cm}^3$$

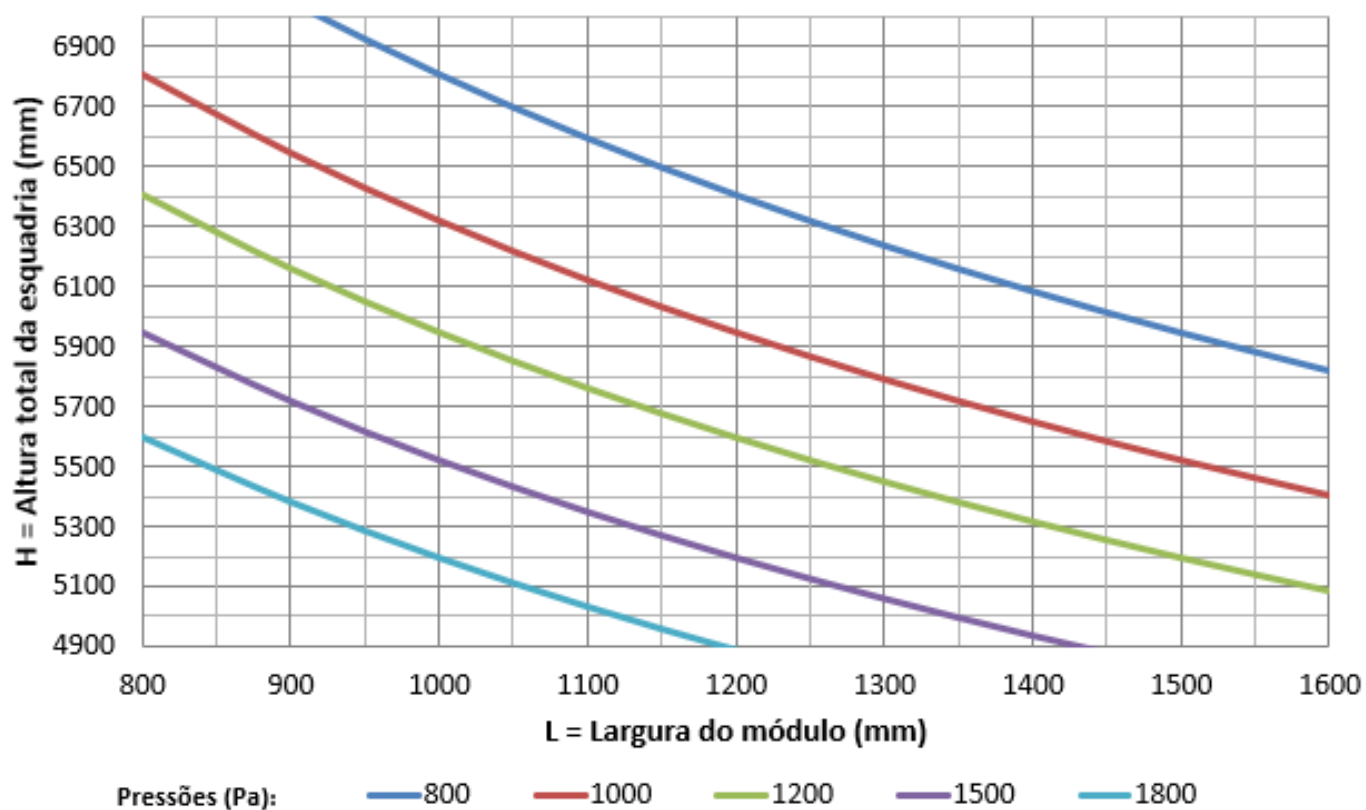

Coluna de 180mm

SPG-6199

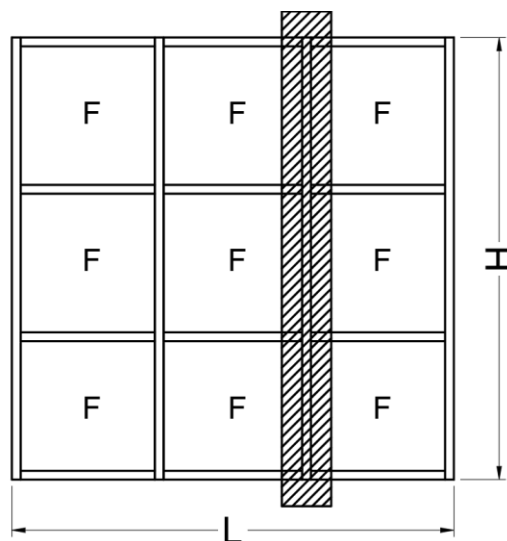
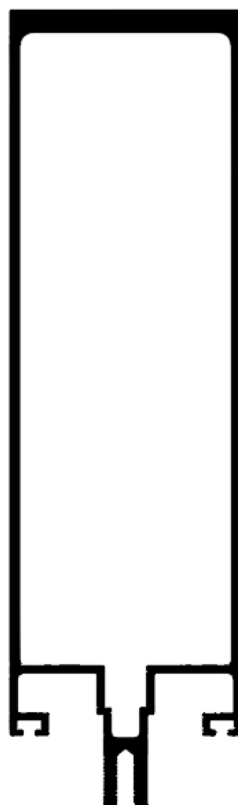

SPG-6199

$$J_x = 446,0937 \text{ cm}^4$$

$$W_x = 44,923 \text{ cm}^3$$

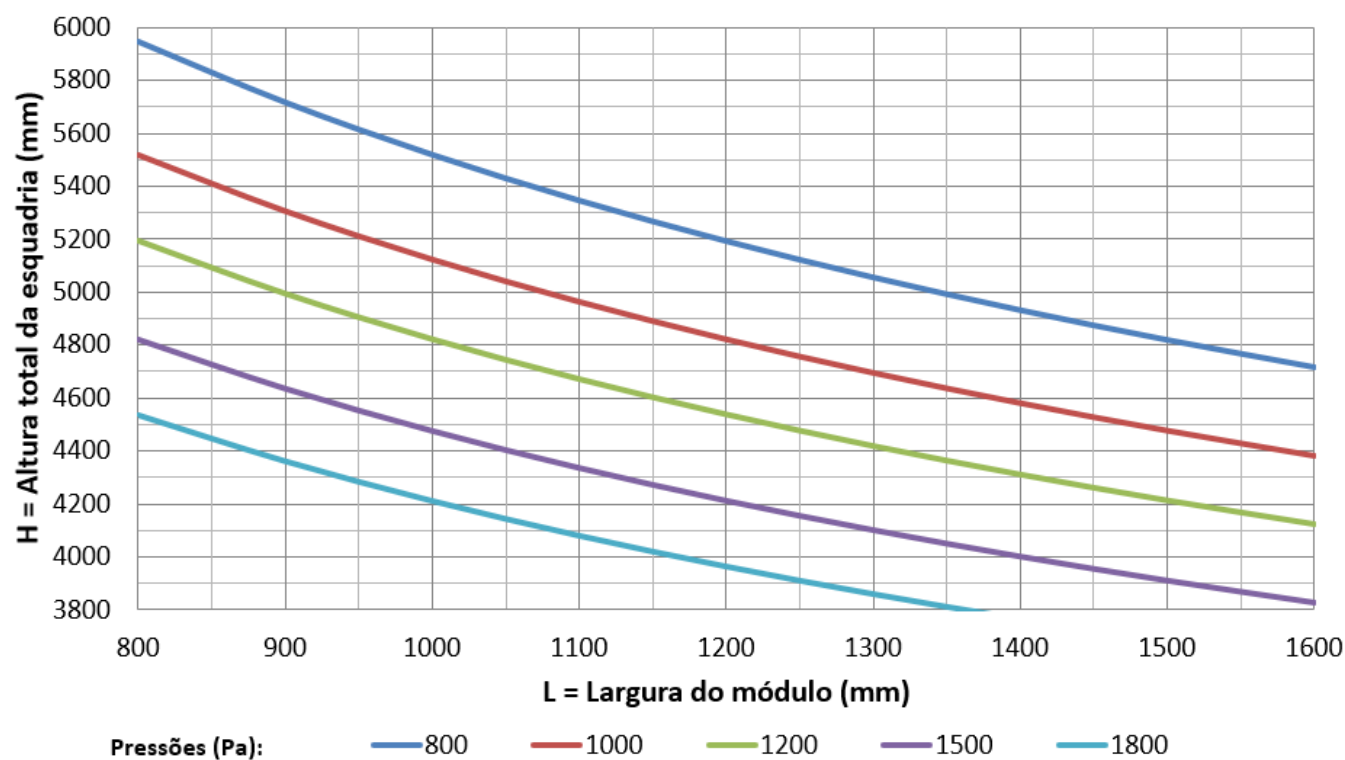

Coluna de 130mm

SPG-6200

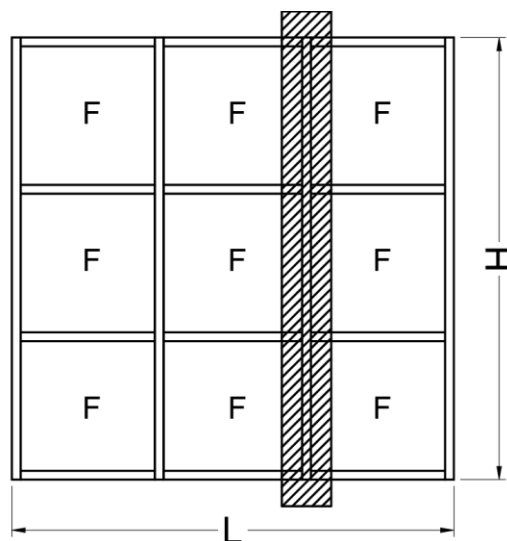

SPG-6200

$$J_x = 158,6235 \text{ cm}^4$$

$$W_x = 25,379 \text{ cm}^3$$

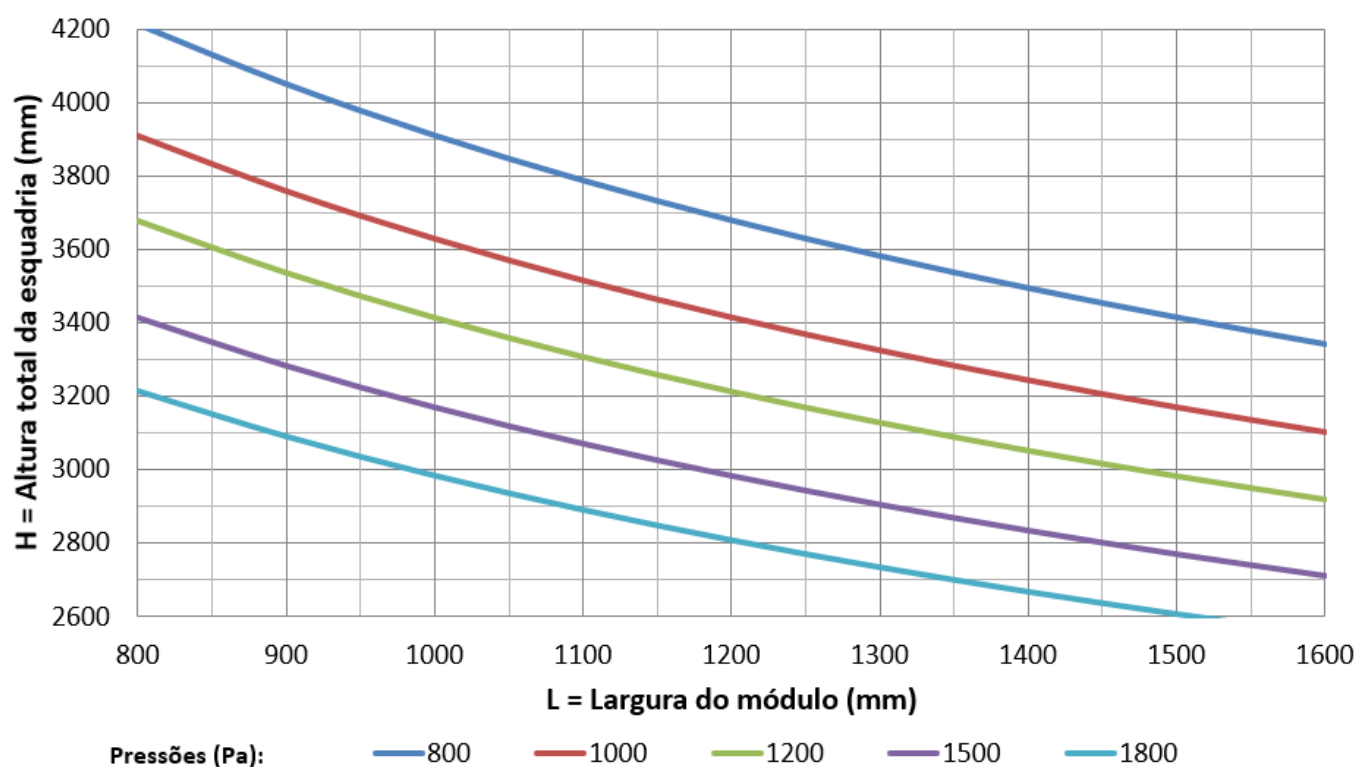

Travessa

SPG-6201

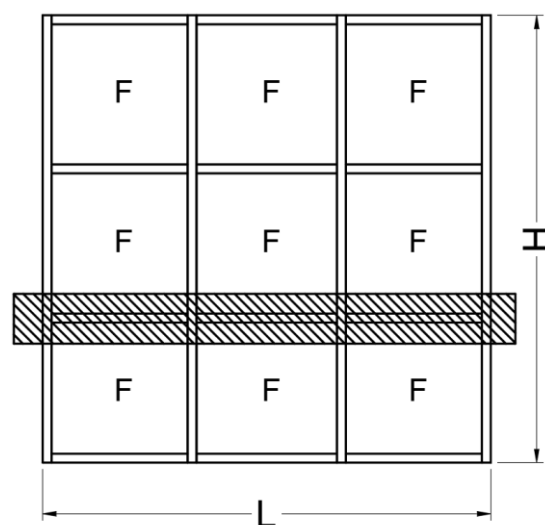
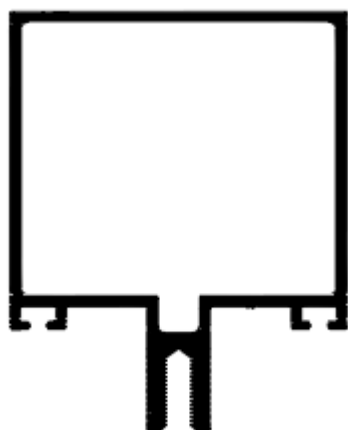

SPG-6201

$$J_y = 12,9660 \text{ cm}^4$$

$$W_y = 4,986 \text{ cm}^3$$

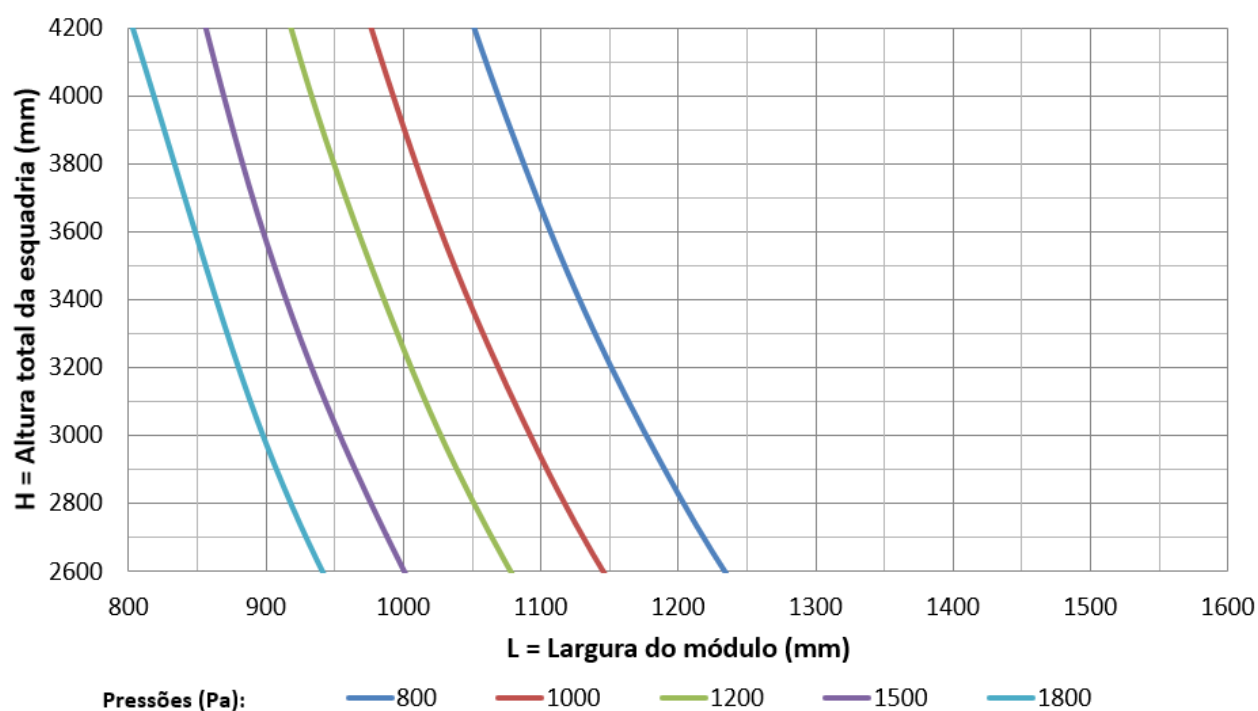

Fachada Simples com "n" módulos

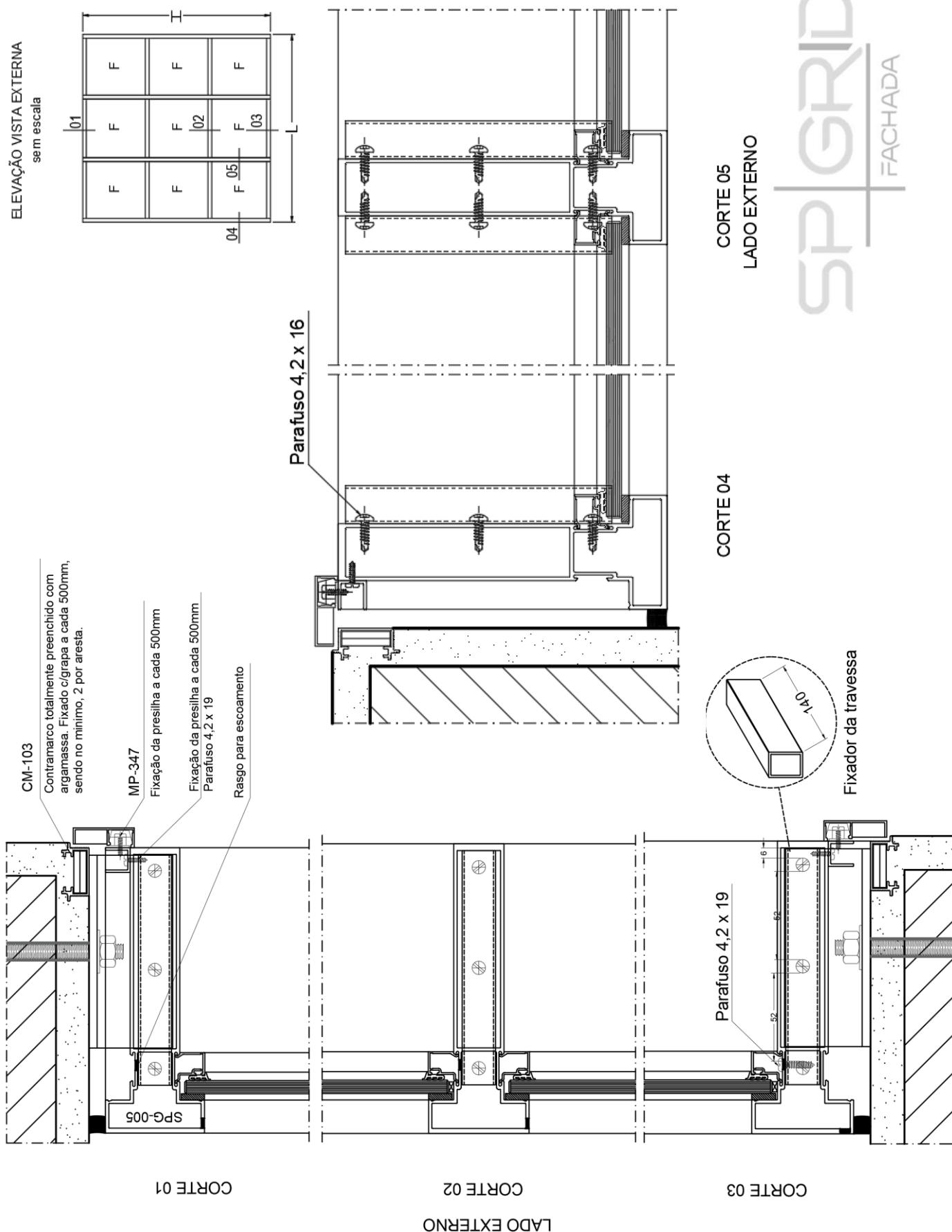

Fachada Simples com Maxim-ar
Inferior com Baguete

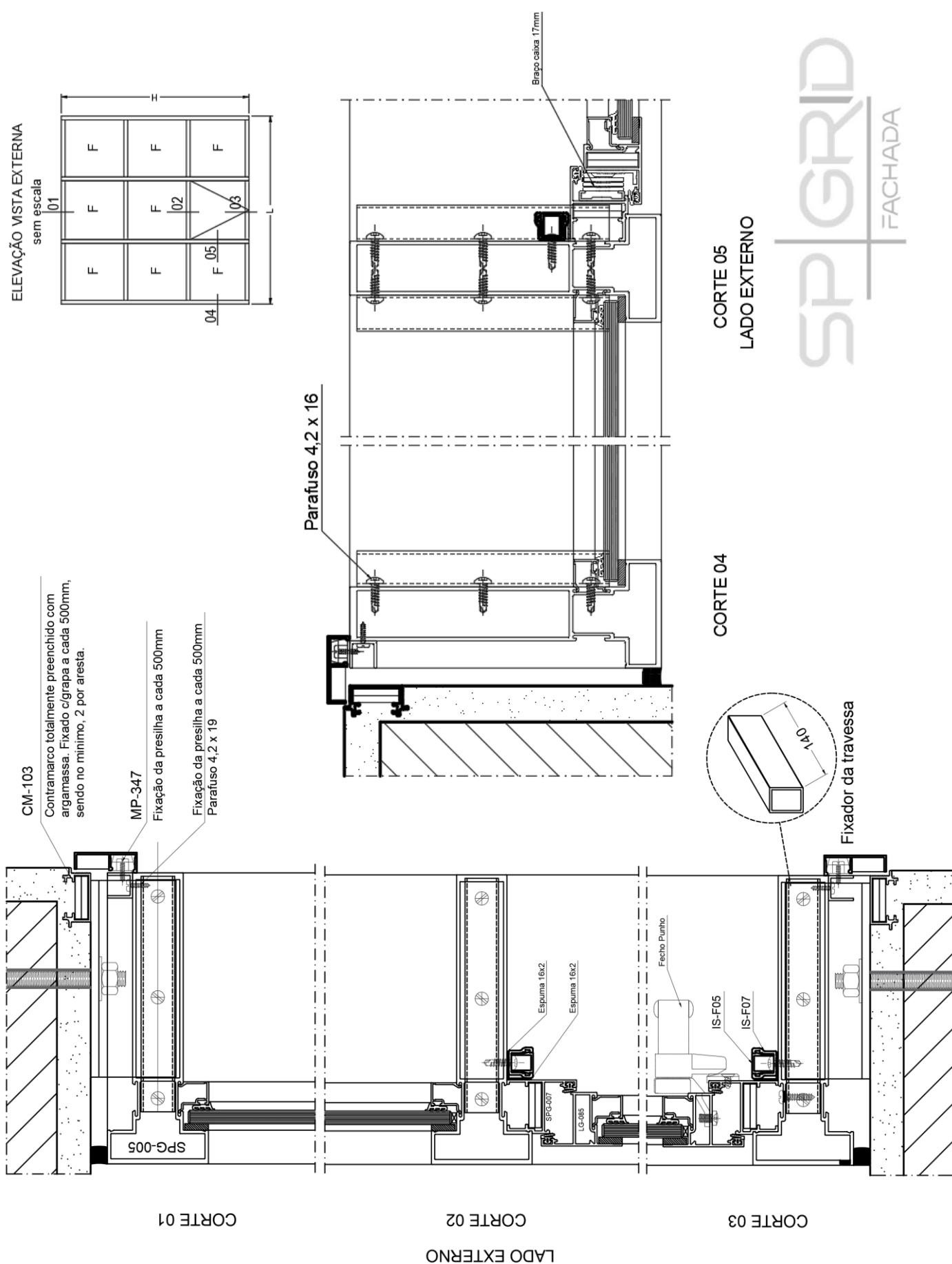

Fachada Simples com Maxim-ar Inferior com
vidro colado sem Baguete

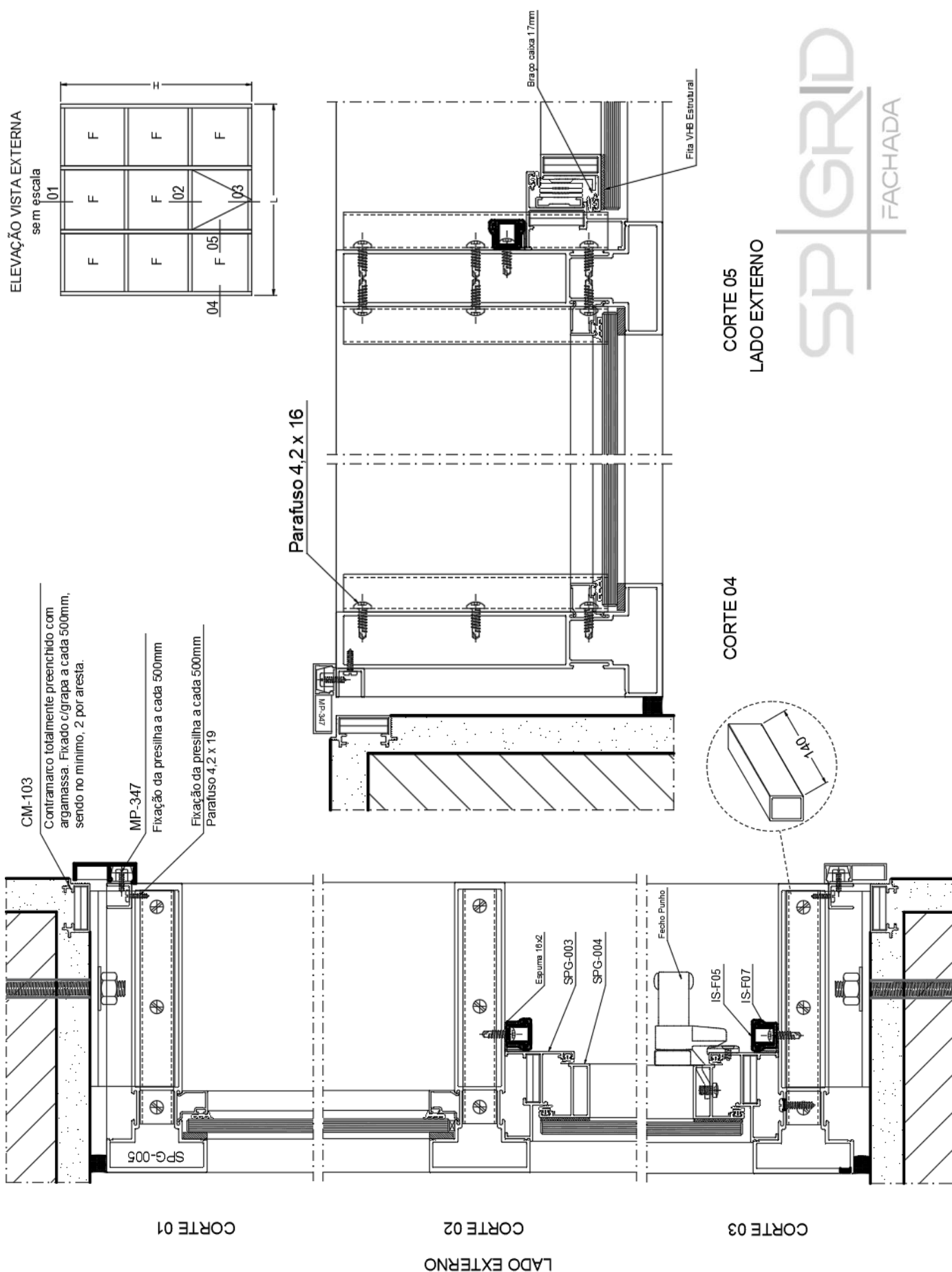

Obrigado,

aluminorte Desde 1986
alumínio e acessórios

Conheça os nossos
sistemas no site:

Acesse o qr code e confira!



Nos acompanhe nas
redes sociais e fique
por dentro!
@aluminorte

Ou entre em contato pelo telefone:
22814822